

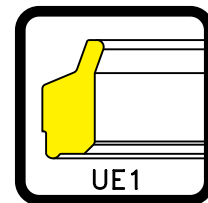

TOPSEAL

SEAL IS SOMETHING · QUALITY IS EVERYTHING

UE1 SERIES PNEUMATIC

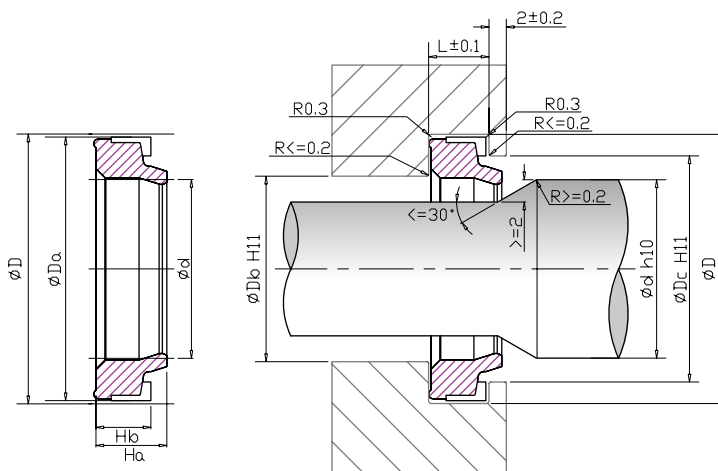

P	PH	S	P	P	S
Working Pressure: ≤ 1.0 Mpa					
Working Temperature: -20°C ~ +225°C					
Surface Speed: ≤ 1.0 m/s					
Hardness	90	Shore A	DIN53505		
Tensile Strength	16.7	Mpa	DIN53504		
	2422	psi	ASTM D-412		
Elongation	139	%	DIN53504		
Compression Set	16.7	%	DIN53517		
70hrs @ 175°C	16.7	%	ASTM D-395		
Standard Compound	V9059AA				
Color	Black ●				

NBR 85 PHYSICAL PROPERTIES					
Working Pressure: ≤ 1.0 Mpa					
Working Temperature: -25°C ~ +100°C					
Surface Speed: ≤ 1.0 m/s					
Hardness	85	Shore A	DIN53505		
Tensile Strength	20.7	Mpa	DIN53504		
	3008	psi	ASTM D-412		
Elongation	130	%	DIN53504		
Compression Set	4.9	%	DIN53517		
24hrs @ 100°C	4.9	%	ASTM D-395		
Standard Compound	N8594AA				
Color	Black ●				

CODE	d (mm)	D (mm)	Ha	Hb	Da	Db	Dc	L
UE10001	4.5	8.0	3.5	2.6	7.7	5.0	6.5	3.1
UE10002	5.0	9.0	4.1	3.2	8.7	5.5	7.0	3.7
UE10003	6.0	10.0	4.1	3.2	9.7	6.5	8.0	3.7
UE10004	8.0	11.6	3.5	2.8	11.3	8.5	10.0	3.3
UE10005	9.5	15.0	4.6	3.7	14.7	10.0	12.0	4.5
UE10006	10.0	18.0	7.8	6.3	17.0	10.5	13.0	7.0
UE10007	12.0	18.0	5.0	4.1	17.8	13.0	15.5	4.8
UE10008	12.0	20.0	7.8	6.3	19.1	13.0	17.0	7.0
UE10009	14.0	22.0	5.5	4.5	21.1	15.0	18.5	5.2
UE10010	14.0	22.0	7.8	6.3	21.5	15.0	19.0	7.0
UE10011	16.0	22.0	5.5	4.5	21.5	17.0	19.5	5.2
UE10012	16.0	24.0	7.8	6.3	23.1	17.0	21.0	7.0
UE10013	18.0	26.0	7.8	6.3	25.1	19.0	23.0	7.0
UE10014	20.0	28.0	7.8	6.3	27.1	21.0	24.0	7.0
UE10015	22.0	30.0	7.8	6.3	29.1	23.0	26.0	7.0
UE10016	25.0	33.0	7.9	6.3	32.1	26.0	29.0	7.0
UE10017	28.0	36.0	7.8	6.3	35.1	29.0	32.0	7.0